

CHAINS

RESTORED CORNER FOR OREGON STATE BOARD OF FORESTRY
One quarter corner common to Sections 3 and 4, T3S,
R8W, W.M., Tillamook County, Oregon.

ORIGINAL

Post (now missing) from which a:

36" Fir bears N17W 42 lks.; now 62", scribes 1/4 S BT. visible in bark.
5" Maple bears S76E 33 lks.; now missing.

RESTORED

Var. 21 1/2 E

Set 1 1/2" x 36" galvanized iron pipe with 3" bronze cap marked "OREGON STATE
BOARD OF FORESTRY 1/4 S4 S3 1958 RS 401", 33 inches in ground, in small
mound of stone, and from which a:

28" Hemlock bears S17E 16.7 ft.; scribed 1/4 S3 BT RS401.
43" Hemlock bears N4W 46.6 ft.; scribed 1/4 S4 BT.

Oregon State Board of Forestry metal location poster on 28" Hemlock BT.
Set 4" x 4" x 48" white painted Cedar post 1' S.W. of pipe.

Dated November 26, 1958.

Restored by

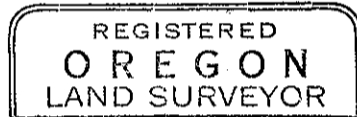

Richard A. Morris

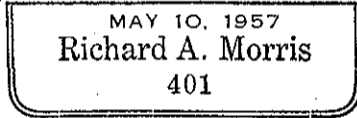

Present and witnessed by Robert Cop
Ronald Schulson
Harold Russell

Book I